

Camden Town Station Capacity Upgrade

Engagement sessions and next steps
March 2017



Our proposals

We believe customers could benefit from:

- A new second entrance and exit to the station
- More escalators
- Step free access from the street to trains
- More space to change between trains
- Improved fire protection and evacuation
- Removing the need for frequent crowd control measures
- Removing one of the remaining obstacles to future frequency increases on the Northern Line



Public engagement

STATION UPGRADE

- In October 2015, a public consultation was carried out to share the station design proposals and request feedback
- 1,744 responses received from residents, commuters, visitors, and local businesses
- 95% of respondents agreed there was a need for a capacity upgrade of the station

OVER-STATION DEVELOPMENT

- In January 2017, a public consultation was carried on proposals for the development above the proposed station upgrade
- 95 responses have been received from the public, nine from stakeholders
- Analysis of results in progress



Proposed Over-Station development

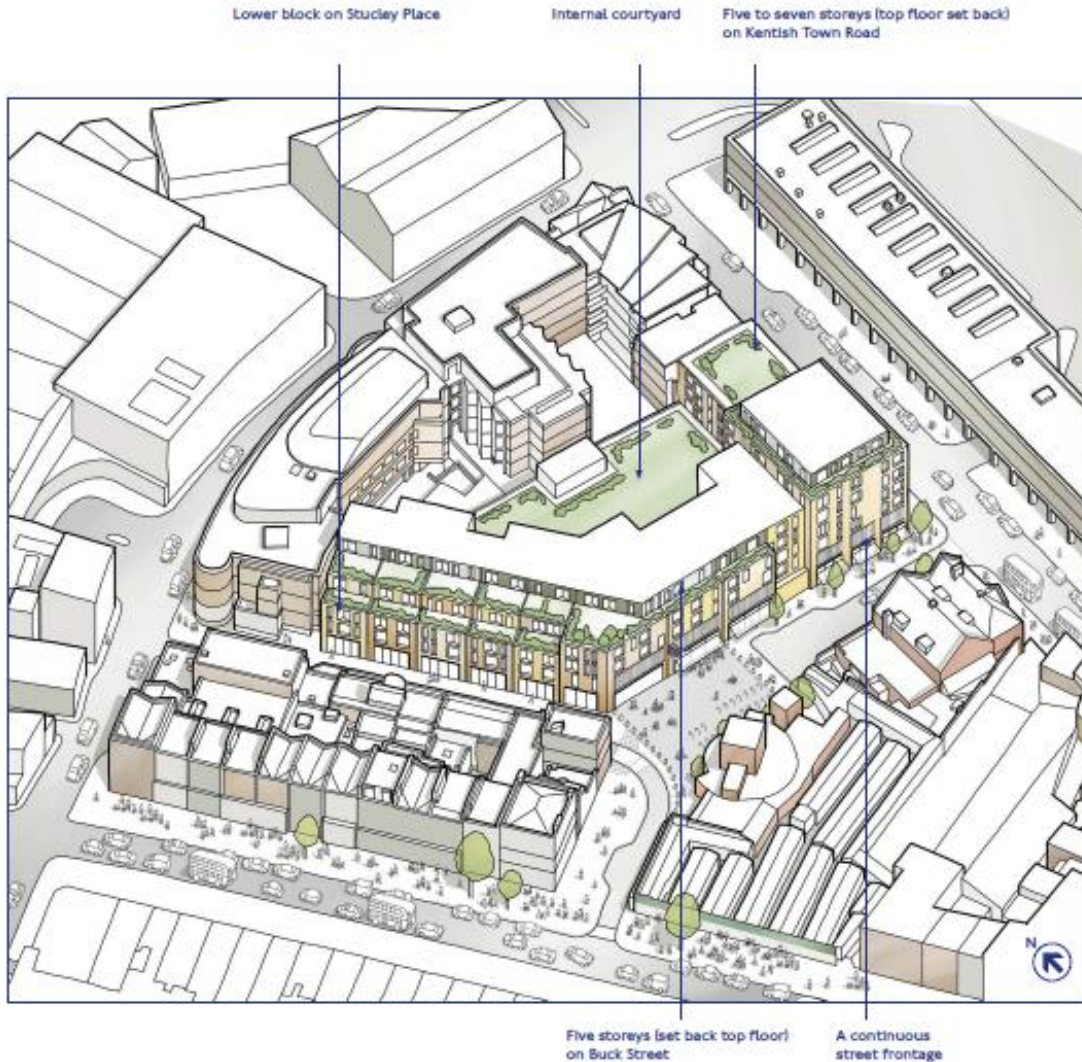

- Delivers 60-70 homes, maximising number of affordable homes
- Targeting 50% affordable homes across all TfL sites
- Camden development currently delivers a minimum of 35% affordable housing
- Activates local streetscape
- Retail space adjacent to new station entrance



Next steps

- **March 2017 - 12 week value enhancement assessing current station design to deliver the most efficient design for the best value**
- **Summer 2017 - Progress Over-Station Development design with planning submission targeted at the end of 2017**
- **Summer 2017 – Second Station Capacity Upgrade consultation**
- **Summer 2017 – Preparation of TWAO documentation**
- **Summer 2018 – Submission of TWA Order**
- **2019 – Public enquiry**
- **2020 – Commencement of main construction works**
- **2024/25 – Station Upgrade complete**

